

Solstice Architecture, Inc.  
Strategic Partner of Ecology House

625 Boulder Road  
Indianapolis, Indiana 46217  
317.781.2898

Consultants:

Scope Drawings:

These drawings indicate the general scope of work in terms of architectural design concept, the dimensions of the building, the mechanical, electrical and the structural, mechanical and electrical systems. The drawings do not necessarily indicate or describe all work required for full performance and completion of the requirements of the contract. On the basis of the general scope indicated or described, the trade contractors shall provide all items required for the proper installation and completion of the work.

Owner:

CasaVerde LLC

Project:

Jackson Place  
Phase One  
11th and Jackson Street  
Columbus, Indiana

Revisions:

Seal:

In progress  
February 18, 2008  
80% Working Drawings

Sheet:

A200

Project Number: 0709

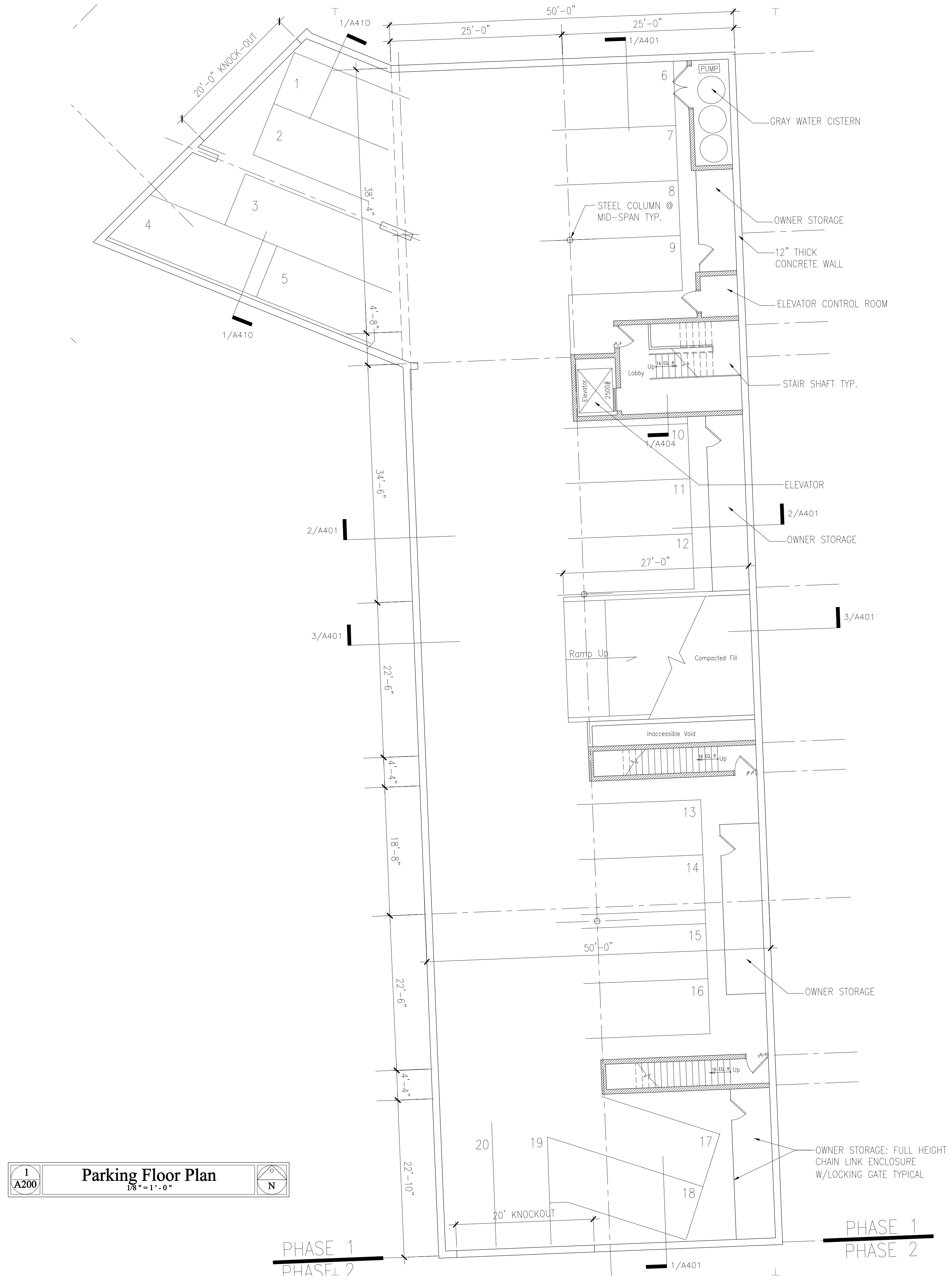

1  
A200  
Parking Floor Plan  
1/8" = 1'-0"  
N

PHASE 1  
PHASE 2

PHASE 1  
PHASE 2